

PRESS RELEASE

RENFORTH RESOURCES INC.

65 Front Street East, Suite 304, Toronto, Ontario, M5E 1B5

RENFORTH COMMENCES GOLD EXPLORATION

Toronto – August 8, 2013 – Renforth Resources Inc. (CNSX: RFR) (“Renforth” or the “Company”) announces that exploration has commenced on the New Alger Gold Project, located outside Rouyn-Noranda Quebec, in the Cadillac Break Mining Camp.

“Renforth is excited to commence ground exploration at New Alger. Earlier this year we grabbed a gold bearing sample between the two historic shafts during a brief property visit. We are looking forward to putting geologists on the ground in order to prospect, map and sample where appropriate, using as a guide historical mapping showing outcropping and prior trenches on the property.” states Nicole Brewster, President and CEO of Renforth.

AREAS OF INTEREST

Renforth has developed two areas of interest to be focused on during this initial exploration campaign, depicted in red in the image below. The two areas consist of (1) an IP anomaly which runs across the property, to the north of the Cadillac Break and (2) the area of the historic discovery showing, depicted on maps most recently dated in the 1980’s.

The area of interest for this exploration campaign is depicted below, if time permits the area where the Cadillac Break has been confirmed at surface by Renforth, between the shafts, will also be examined.

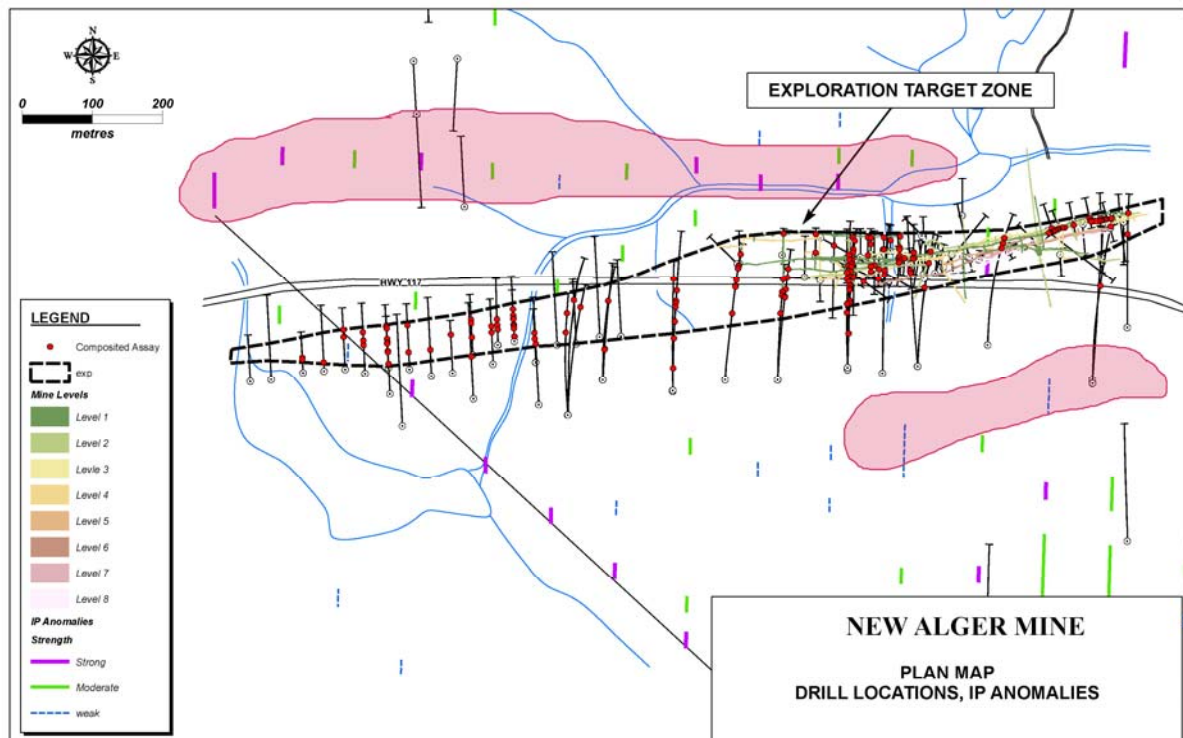

Technical information contained in this press release has been reviewed and approved by Brian H. Newton P. Geo, a qualified person pursuant to the definitions of National Instrument 43-101.

ABOUT RENFORTH

Renforth Resources Inc. is a Toronto-based exploration company with interests in two exploration assets: the previously productive New Alger property, located in the Cadillac Break Mining Camp, Québec, and the Mink Lake Project, located outside of Red Lake, Ontario, in a setting interpreted to be similar to the adjacent Springpole Mine Project.

For further information please contact:

Renforth Resources Inc.

Nicole Brewster

President and Chief Executive Officer

T: (416) 368.5049 F: (416) 368.3151

E: nicole@renforthresources.com

No securities regulatory authority has approved or disapproved of the contents of this news release.